



= Existing Parking Restrictions 'No Waiting' 8am to 4pm Mon-Fri (Following implementation of Safer Routes to School Scheme).

= Proposed New Parking Restrictions 'No Waiting' 8am to 4pm Mon-Fri (Poole Street)



© Crown Copyright and database right 2016
Ordnance Survey 100019566

Project TRAFFIC REGULATION ORDERS		Location POOLE STREET, STOURBRIDGE		Date OCT 17	Revision No 		
Title PROPOSED PARKING RESTRICTIONS		Drawing No TM 4234	Scale 1:1250	Drawn By ARC	Checked By JMB		
						Description	Author
						Project Manager	Date

Place Directorate
 Traffic & Road Safety
 4 Ednam Road
 Dudley DY1 1HL
 www.dudley.gov.uk



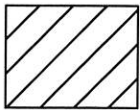
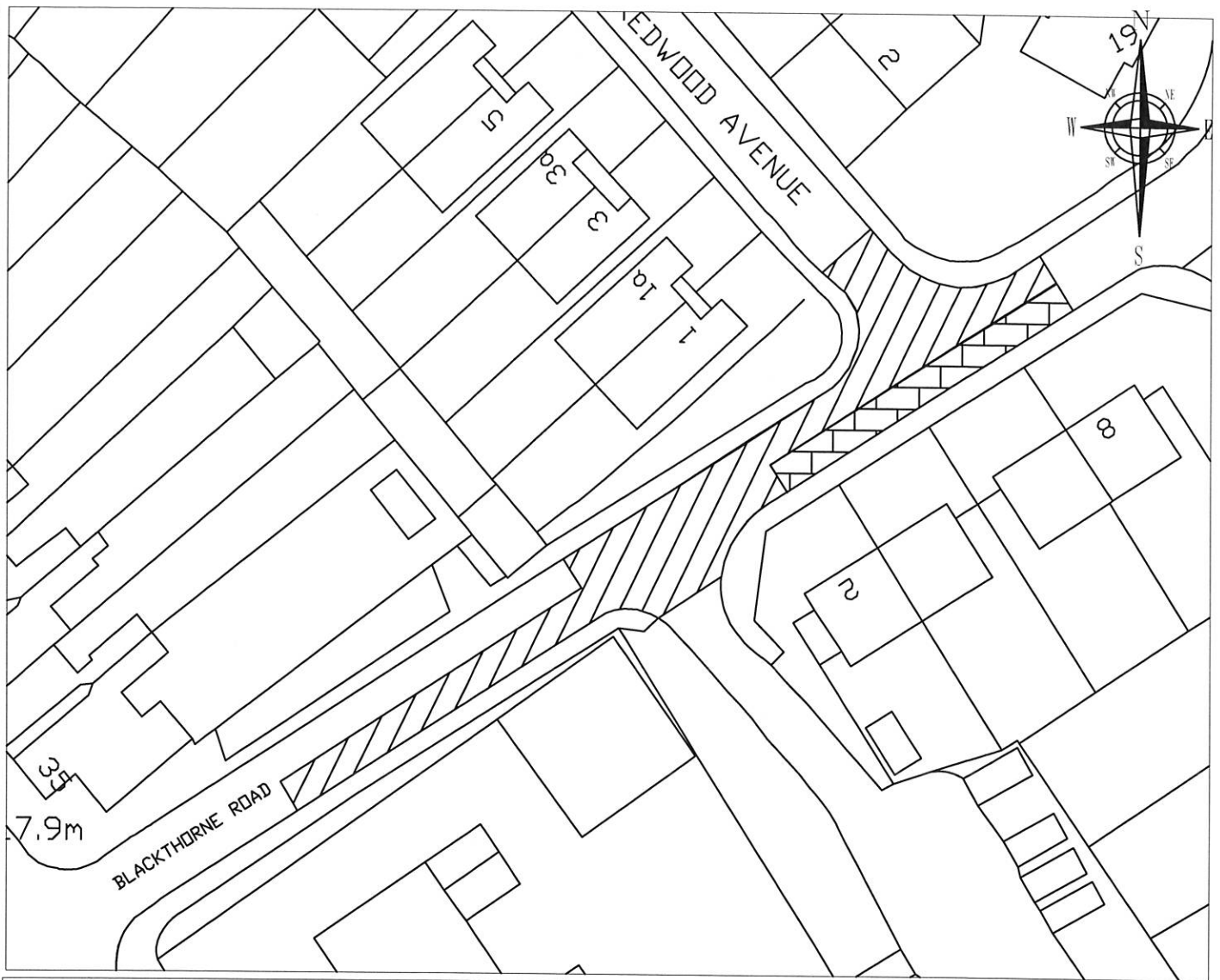

Existing Prohibition of Waiting

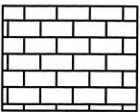

Proposed Prohibition of Waiting

© Crown Copyright and database right 2016.
Ordnance Survey 100019566

Place Directorate

Traffic & Road Safety
4 Ednam Road
Dudley DY1 1HL
www.dudley.gov.uk



Project Title		Proposed Prohibition of Waiting Blackthorne Road, Dudley		Drawing No. TM 4238	
Drawn By	Checked By	Revision No.	Date	Scale	
JK			Sept 2017	1:500 @ A4	

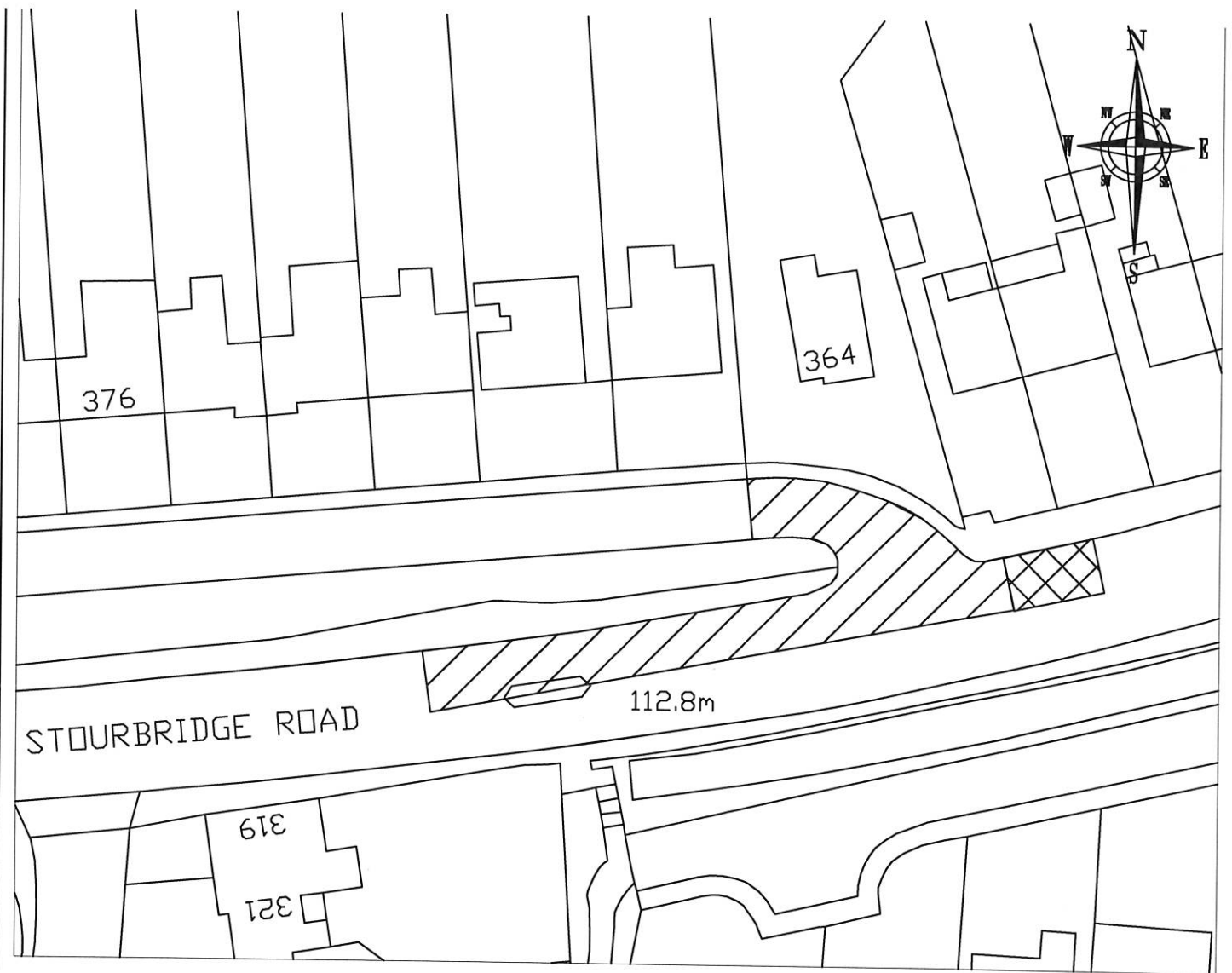

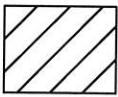
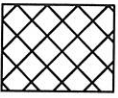
	Existing Prohibition of Waiting
	Revocation of Prohibition of Waiting

© Crown Copyright and database right 2016.
 Ordnance Survey 100019566

Place Directorate

Traffic & Road Safety
 4 Ednam Road
 Dudley DY1 1HL
www.dudley.gov.uk



Project Title Proposed Revocation of Prohibition of Waiting Stourbridge Road, Halesowen			Drawing No. TM4138/A	
Drawn By JK	Checked By	Revision No. A	Date Oct 2017	Scale 1:500 @ A4