

BOROUGH OF DUDLEY

NOTICE OF PUBLIC PATH ORDER FOR DEVELOPMENT
OR PLANNING PURPOSES

TOWN AND COUNTRY PLANNING ACT, 1990 SECTION 257
AND PARAGRAPH 1 OF SCHEDULE 14

VULCAN WORKS, HAYES LANE, LYE,
STOURBRIDGE, WEST MIDLANDS

The above order was made on 15 August 2018. The effect of the Order will be to stop up the whole length of public footpath S89 and part of the length of public footpath H240. Footpath S89 commences adjacent to No 74 Hayes Lane, Lye, Stourbridge, West Midlands, heading to a generally easterly direction for some one hundred and seventy (170) metres to terminate at the western side of the Stourbridge to Birmingham Railway Line whereafter the path continues (in tunnel) as public footpath H240 for some fifteen (15) metres to meet public footpath S90 on the eastern side of the said railway line as indicated on Plan D030.

A copy of the order and the order map may be seen free of charge at Place Directorate, 4 Ednam Road, Dudley, DY1 1HL from 9 am to 5 pm on Monday to Friday. Copies of the order and map may be bought there at the price of £2.00.

Any representation about or objection to the order may be sent or delivered in writing addressed to David Jacobs, Place Directorate, 4 Ednam Road, Dudley, DY1 1HL not later than 12 September 2018. Please state the grounds on which it is made.

If no such representations or objections are duly made, or if any so made are withdrawn, the Borough Council of Dudley may itself confirm the order as an unopposed order. If the order is sent to the Secretary of State for Transport for confirmation any representations and objections which have not been withdrawn will be sent with the order.

DATE: 1 August 2018

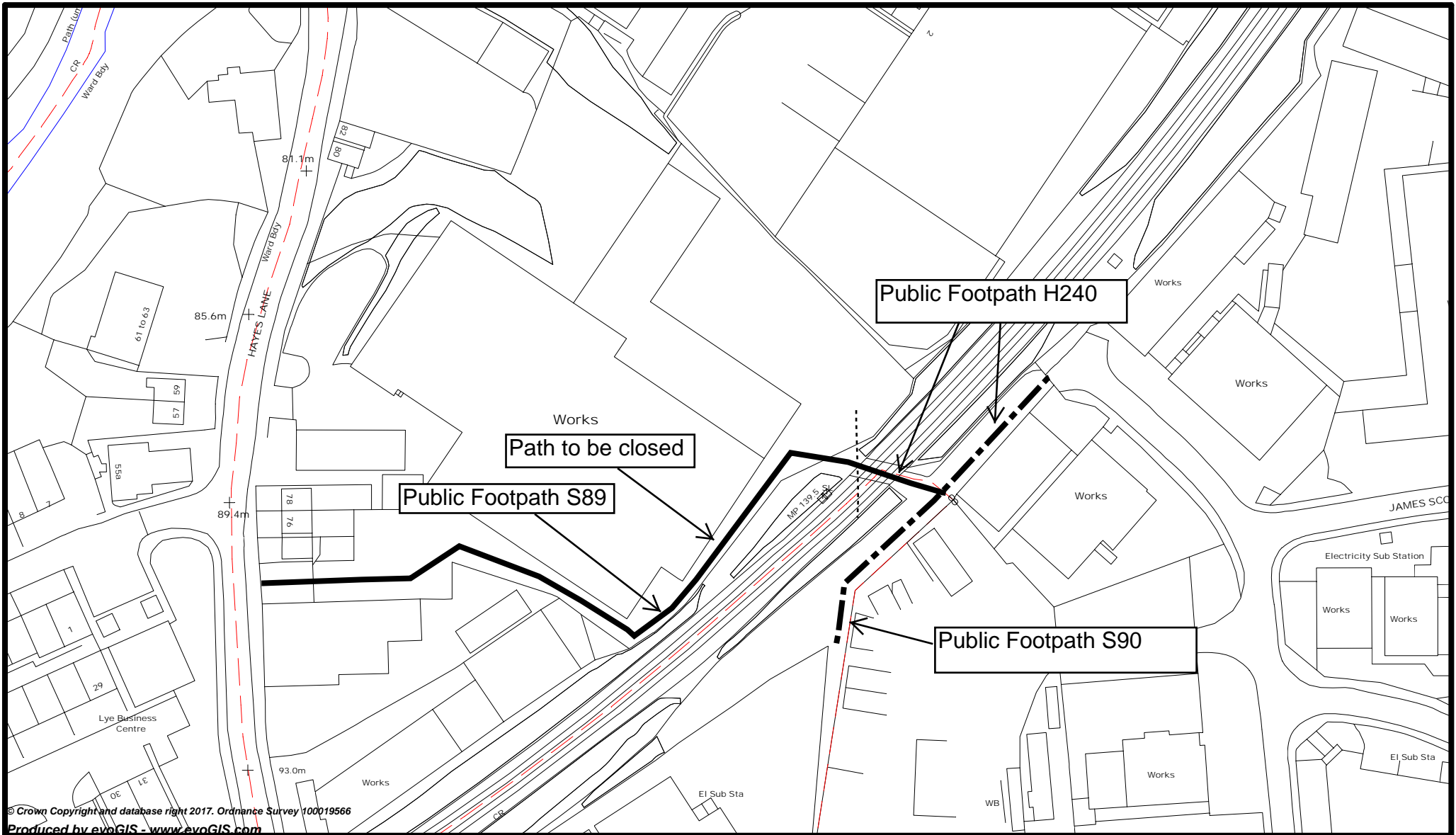

© Crown Copyright and database right 2017. Ordnance Survey 100019566
 Produced by evoGIS - www.evoGIS.com

TITLE:
**Proposed Closure of Public Footpath
 S89 Hayes Lane
 Lye Stourbridge**



SCALE:
 1 : 1250
 DATE:
 01-SEP-2017

Place Directorate
 Environmental Services Division
 4 Ednam Road
 Dudley
 DY1 1HL

CREATED BY:

DH Plan Number D030

